

Grade II and III certified lightweight panels and doors for flexible security enclosure construction



# ModuleGuard

BURGLARY-RESISTANT PROTECTION

## Key Features

- ModuleGuard security enclosures are certified Grade II and III by ECB•S in accordance with the EN 1143-1 certification for burglary resistance.
- The rooms also offer approved protection against certain firearms.
- The security enclosures are constructed using modular, lightweight panels.
- The light weight reduces transportation costs, eases installation and allows for placement higher up in buildings where floor loads are limited.
- The modular construction means assembly, disassembly and expansion of a room is both quick and easy.
- The security enclosures can be built into the existing structure of a building and customised to meet the required dimensions.
- Possible application are: reinforced protection for cash-counting rooms, archives, storerooms (for weapons, pharmaceuticals), ATMs, etc.
- A series of high-security locking options is available.
- The exterior of the enclosure can be painted or finished with decorative panels. Pre-painted or galvanised version available as an option.



**Chubb**safes  
*Trusted the world over.*

SECURITY  
ENCLOSURES

## Product Specifications

ModuleGuard Doors, Dimensions (mm)						
Door width (clear opening in mm)	750	900	1050	1200	1350	1500
Door thickness	75	75	75	75	75	75
Door weight (kg) (door within a room)	490	600	710	820	930	1040
Door weight (kg) (stand-alone door)	675	785	895	1005	1115	1225

NB: Grade II & III doors are the same weight.

ModuleGuard Panels, Dimensions (mm)				
Width	300	600	750	900
Thickness	75	75	75	75
Height	2240	2240	2240	2240
Weight (kg) Grade II	69	137	171	206
Weight (kg) Grade III	73	146	182	219
Floor load	Floor load depends on the size of the enclosure.			

## Minimum Room Measurements

To be certified, the room must be six-sided and fulfil minimum dimensions as given to the right.

Minimum room measurements (mm)	External	Internal
Height	2290	2140
Width	2445	2295
Depth	1545	1395
Weight (kg)	3000	

The specifications given are the minimum size for a certified ModuleGuard enclosure. Larger sizes can be made to order. Please note, for extra large dimensions, an additional frame structure may be required for support.

## Burglary Testing

ModuleGuard has been approved by ECB•S in accordance with the European standard, EN 1143-1, for burglary protection in Grades II and III.

A range of attack tools were used to test ModuleGuard's level of resistance, from basic tools, such as drills and sledgehammers, to more sophisticated thermal and electrical equipment, like the oxyacetylene torch.

ModuleGuard has also been granted Grade 4 level according to the EN 1627-1630 standard. It has also undergone certified ballistics test and has been certified level FB4 in accordance with EN 1522.

## Locks

Z03 D-drive, SafeLock series, LG 33E, LG 66E, LG 1947, S&G 6731, Kaba Mauer 70076.

Authorised dealer:

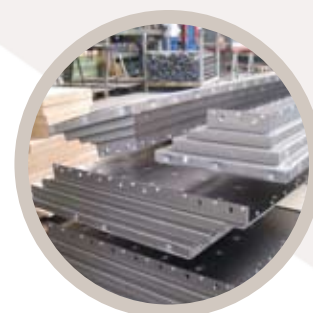
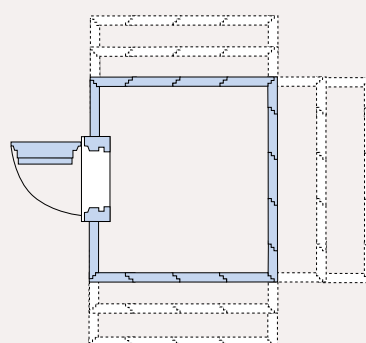

**Chubbsafes**  
Trusted the world over.

[www.chubbsafes.com](http://www.chubbsafes.com)

'Chubb' is owned by Chubb plc and is a registered trademark used under license